

尺寸/Dimensions 单位/Unit=mm

RoHS
COMPLIANT

CE

60CM11 V2.0

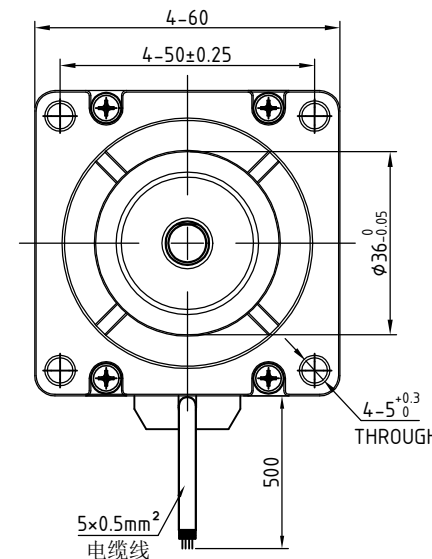
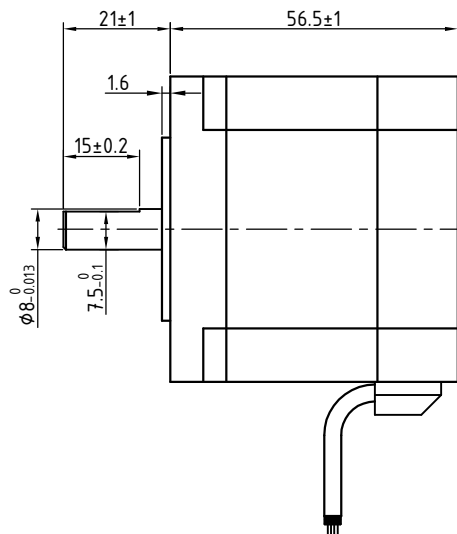
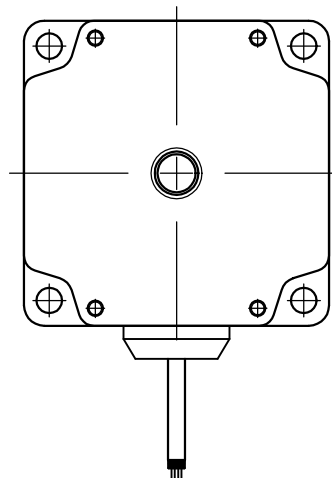

电动机规格书/Motor Specification

相数/Number Of Phase	5
基本步距角/Basic Step Angle	0.72°
基本步距角误差(空载)/Positional Accuracy(no-load)	±5%以下/Max
额定电压(相)/Rated VOLTAGE(Phase)	V(DC)
额定电流(相)/Rated Current(Phase)	2.4A
电阻(相)/Resistance(Phase)@20°C	0.42Ω±15%
电感(相)/Inductance(Phase)@1KHz	1.1mH±20%
保持力矩/Holding Torque	1.15N·m
转子惯量/Rotor Inertia	≈280g·cm²
质量/Mass	0.8Kg
径向跳动(最大)/Radial Play(Max)	0.025mm(Load/负载 450g)
轴向跳动(最大)/Axial Play(Max)	0.075mm(Load/负载 920g)
额定工作状态/Duty	连续/Continuous
绝缘耐压/Dielectric Strength	500V A.C
绝缘电阻/Insulation Resistance	100MΩ Min/500VDC
绝缘等级(UL)/Insulation Class(UL)	B
温升/Temperature Rise	80K以下/Max
使用温度范围/Operation Ambient Temperature	0°C~+50°C
使用湿度范围/Operation Ambient Humidity	20%RH~90%RH
保存温度范围/Storage Ambient Temperature	-20°C~+70°C
保存湿度范围/Storage Ambient Humidity	15%RH~95%RH

接线图/Wiring Diagram

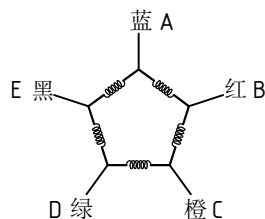

励磁顺序 (5相励磁)
Phase Sequence(5 Phase Exciting)

铭牌内容/Label Discription

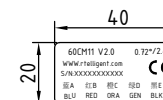

第一角画法
First Angle View

05						批准 Approved			材 质 Material	
04						审核 Checked			表面处理 Finish	
03						设计 Designed	HXY	23.02.20	公差 Tolerance	±0.2
02						制图 Drawn			NO.	
01					24.07.02				比例 Scale	1:1
00									页 Sheet	1/1
版本 Edition						设计 Designed	日期 Date			

机身长度加长, 端盖更改
初版/First Edition

变更内容
Revisions